



## DIWA Series

*Submersible pumps for clean and dirty water.*

*Entirely made from AISI 304 stainless steel, compact and lightweight, with mechanical seal and coated diffuser plate for maximum resistance to abrasion.*

*Supplied with or without float switch. Most pump models feature a built-in capacitor. The motor is cooled by the pumped liquid and thermal overload protection to protect the pump in case of overheating.*

3

### SPECIFICATIONS

**Delivery:** up to 25 m<sup>3</sup>/h

**Head:** up to 21 m

**Power supply:** three-phase and single-phase 50 and 60 Hz

**Power:** 0.55 kW to 1.5 kW

**Maximum immersion depth:** 7 m

**Temperature of pumped liquid:** 0°C to +50°C

**Liquids with suspended solids:** up to 8 mm

**Insulation class:** F (motor dry)

**Protection:** IP68

**Length of cable:** 10 m

### MATERIALS

**Pump body, motor casing:** Stainless steel

**Sleeve, impeller:** Stainless steel

**Shaft extension, butts and bolts:** Stainless steel

**Suction screen:** Stainless steel

**Front diffuser plate:** Stainless steel coated with polyurethane

**Inner mechanical seal:** Silicon-carbide/Silicon-carbide

**Upper lip seal:** NBR

**Handle:** Stainless steel coated in polyacetal resin

**Elastomers:** NBR



### APPLICATIONS

- Emptying of drains, rain water tanks or domestic wastewater
- Emptying of wells and tanks in industrial and ecological applications
- Lawn and garden irrigation
- Emptying of tanks and reservoirs
- Emergency draining of flooded areas or rooms

For a complete list of technical information, consult [www.lowara.com](http://www.lowara.com)

*Engineered for life*



### DIWA SERIES

### OPERATING CHARACTERISTICS AT 50 Hz

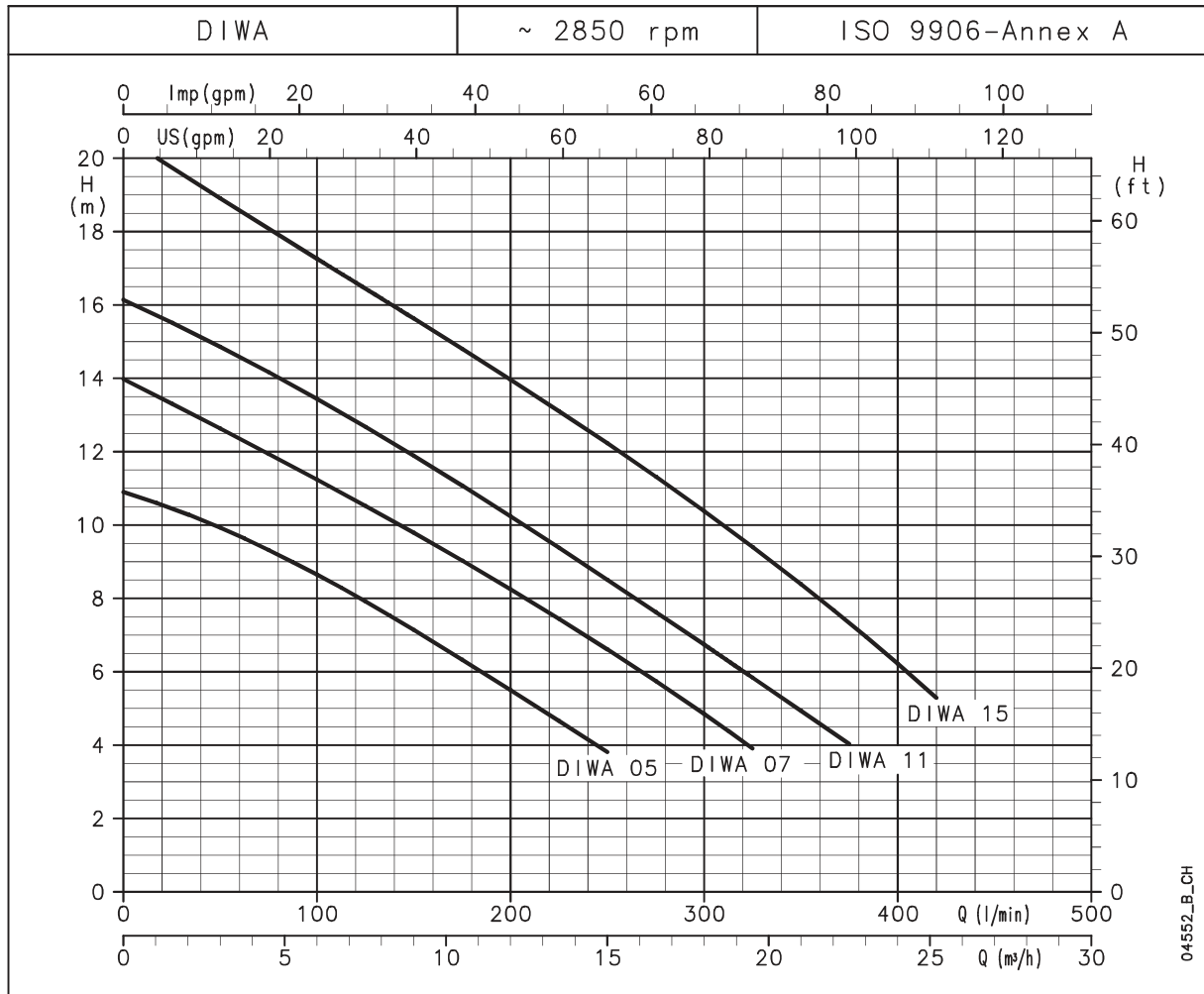



### DIWA SERIES HYDRAULIC PERFORMANCE TABLE

PUMP TYPE	RATED POWER		Q = DELIVERY												
			l/min	0	100	125	150	175	200	225	250	300	325	375	420
			m <sup>3</sup> /h	0	6	7,5	9	10,5	12	13,5	15	18	19,5	22,5	25,2
		H = TOTAL HEAD IN COLUMN OF WATER (METRES)													
	kW	HP													
DIWA 05(T)	0,55	0,75	10,9	8,6	7,9	7,1	6,3	5,5	4,7	3,8					
DIWA 07(T)	0,75	1	14,0	11,2	10,5	9,8	9,0	8,3	7,4	6,6	4,8	3,9			
DIWA 11(T)	1,1	1,5	16,1	13,4	12,7	11,9	11,1	10,2	9,4	8,5	6,7	5,8	4,0		
DIWA 15T	1,5	2	20,6	17,3	16,4	15,6	14,8	14,0	13,1	12,2	10,4	9,4	7,3	5,3	

These performances are valid for liquids with density  $\rho = 1.0 \text{ kg/dm}^3$  and kinematic viscosity  $\nu = 1 \text{ mm}^2/\text{s}$ .

diwa-2p50\_a\_th

### ELECTRICAL DATA

PUMP TYPE	INPUT POWER*	INPUT CURRENT*	CAPACITOR
SINGLE-PHASE		220-240 V	
	kW	A	$\mu\text{F} / 450 \text{ V}$
DIWA 05	0,79	3,92	16
DIWA 07	1,25	6,20	22
DIWA 11	1,53	6,83	30
-	-	-	-

\*Maximum value in specified range

PUMP TYPE	INPUT POWER*	INPUT CURRENT*	INPUT CURRENT*
THREE-PHASE		220-240 V	380-415 V
	kW	A	A
DIWA 05T	0,72	2,56	1,48
DIWA 07T	1,2	4,26	2,46
DIWA 11T	1,44	4,64	2,68
DIWA 15T	2,05	6,74	3,89

diwa-2p50\_a\_te



### DIWA SERIES - DIMENSIONS AND WEIGHTS

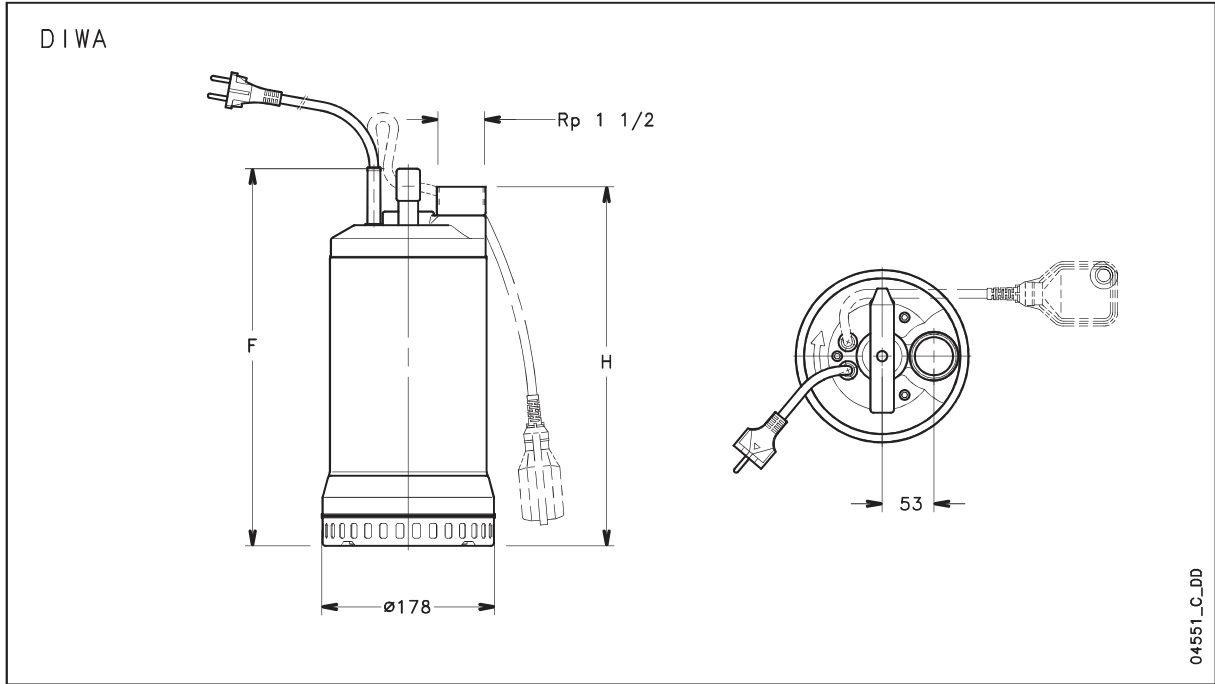

3

PUMP TYPE SINGLE-PHASE		DIMENSIONS (mm)		WEIGHT
		F	H	kg
DIWA05	DIWA05 GT	348	330	12
DIWA07	DIWA07 GT	393	375	14,3
DIWA11	DIWA11 GT	393	375	17
-	-	-	-	-

PUMP TYPE THREE-PHASE		DIMENSIONS (mm)		WEIGHT
		F	H	kg
DIWA05T		348	330	11
DIWA07T		363	345	13
DIWA11T		393	375	15
DIWA15T		393	375	16,5

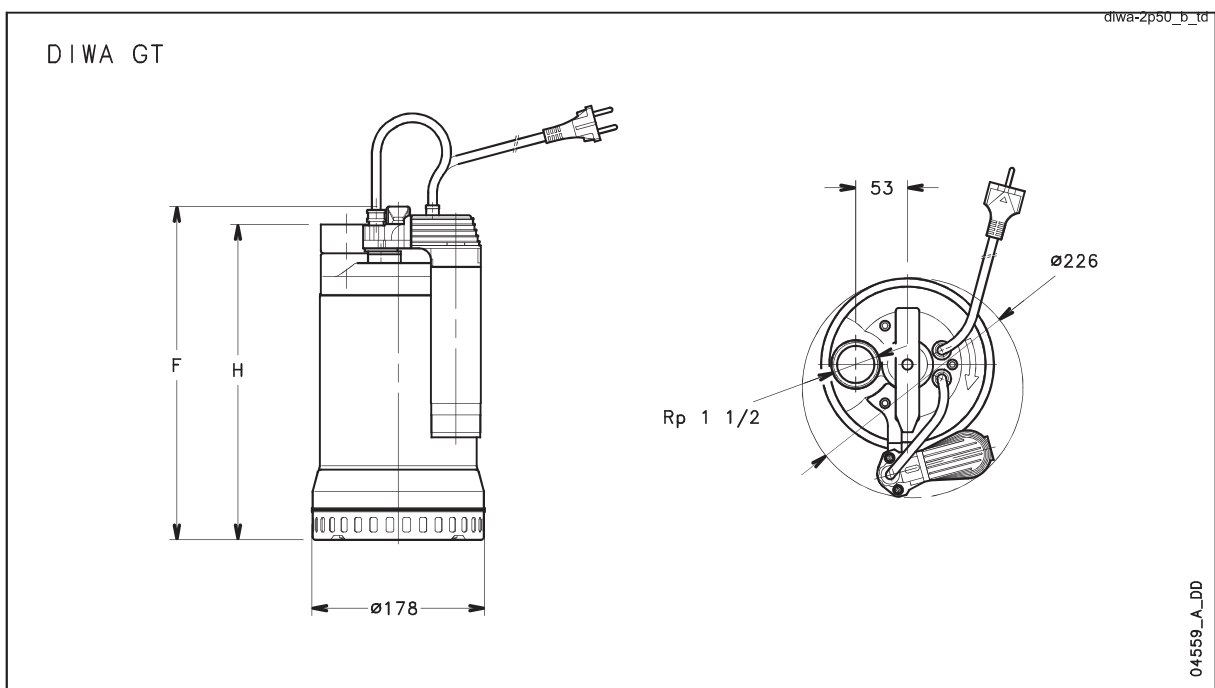



### DIWA SERIES – INSTALLATION EXAMPLES

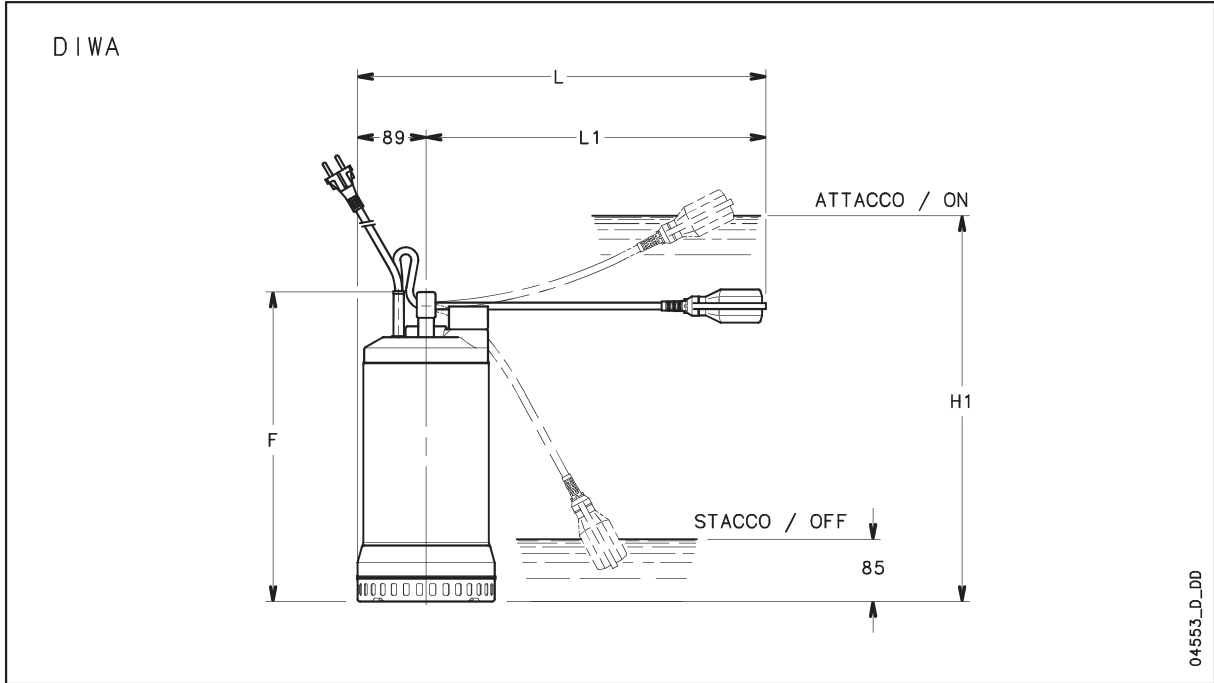

3

PUMP TYPE		DIMENSIONS (mm)				
		F	L	L1	H1	H2
DIWA05	DIWA05 GT	348	459	370	430	180
DIWA07	DIWA07 GT	393	514	425	490	180
DIWA11	DIWA11 GT	393	514	425	490	180

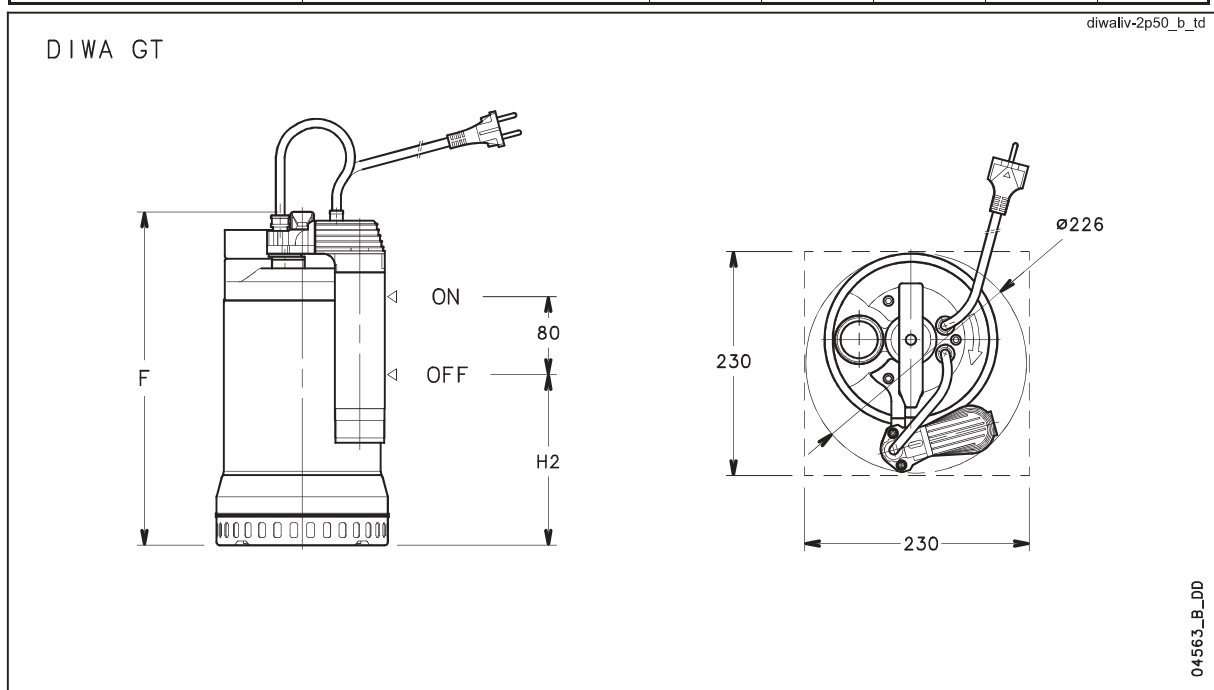



## DN Series

*Submersible pumps for dirty water.  
Made in cast iron and stainless steel, with mechanical seal and open impeller with abrasion-resistant rubber coating.  
Supplied with or without float switch.*

### SPECIFICATIONS

**Delivery:** up to 17 m<sup>3</sup>/h

**Head:** up to 20 m

**Power supply:** three-phase and single-phase 50 and 60 Hz

**Power:** 0.55 kW to 0.75 kW

**Maximum immersion depth:**  
5 m

**Temperature of pumped liquid:**

0°C to +50°C (with fully submerged pump)

0°C to +25°C (with partially submerged pump)

**Liquids with suspended solids:**  
up to 5 mm

**Protection:** IP68

**Length of cable:** 5 m

### MATERIALS

**Pump body:** Cast iron

**Wear flange, motor casing,**

**suction screen:** Stainless steel

**Impeller:** Stainless steel and NBR

**Mechanical seal:** Carbon/Ceramic/NBR

**Elastomers:** NBR

**Shaft extension:** Stainless steel

### APPLICATIONS

- Emptying of drains, rain water tanks or domestic wastewater
- Emptying of wells and tanks in industrial and ecological applications
- Lawn and garden irrigation
- Emptying of tanks or reservoirs
- Emergency draining in flooded areas

